



# Challenger<sup>®</sup> 120

## Down Hole Hammer

### FEATURES

- For use in any hard rock application
- Valveless down hole hammer design
- Designed to operate at pressures up to 250 PSI (17.0 BAR)
- Twelve splined chuck/bit design provides increased contact area
- Suitable for drilling oil & gas wells, water wells, piling holes, elevator shaft holes and other construction jobs where large volume rock excavation is required

### AIR CONSUMPTION

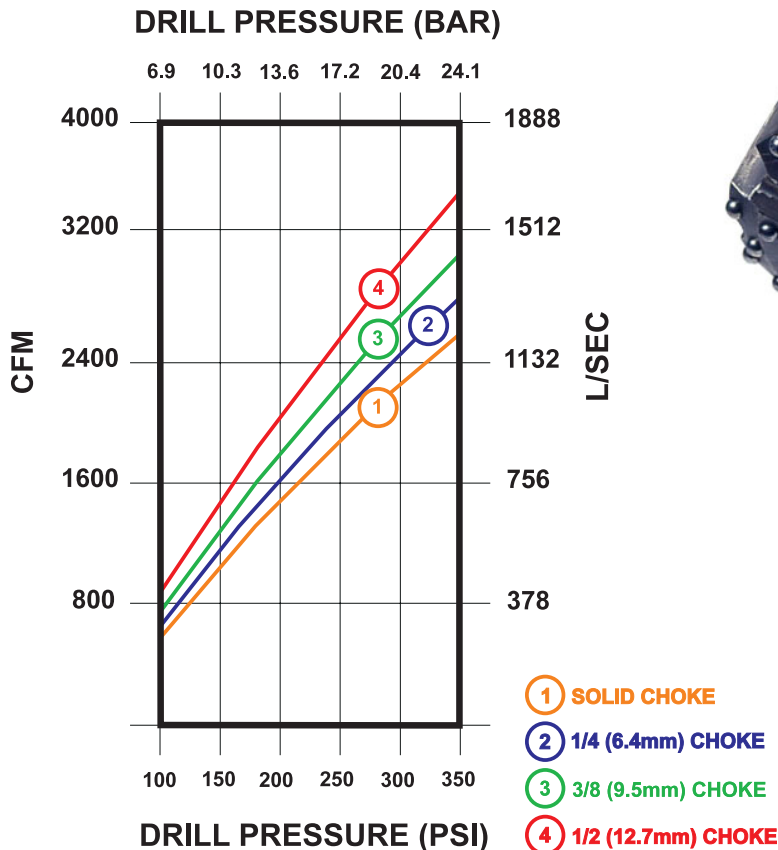

### SPECIFICATIONS

Diameter	10-1/8"	257 mm
Bore	8-1/2"	216 mm
Stroke	5"	127 mm
Weight (Hammer only)	1212 lbs.	550 kg
Length (Shoulder to Shoulder)	74"	188 cm
Length (Shoulder to Bit Face)	83"	211 cm
A.P.I. Reg. Threads	6-5/8"	

- 1300 blows per minute at 250 PSI (17.0 BAR)
- Drills holes from 11-7/8" to 17-1/2" (302 mm - 445 mm) in diameter
- Accepts P120 bit shank



# Down Hole Button Bits

## Challenger® 120

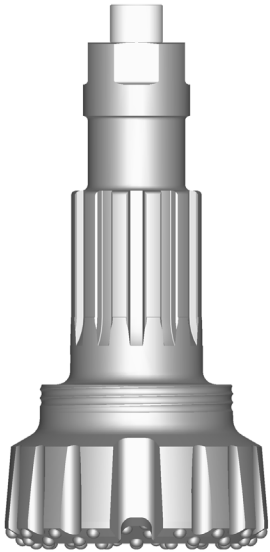

P120 Bit Shank

**DIAMETER**  
inches (millimeters)

11-7/8"	(302 mm)
12-1/4"	(312 mm)
12-3/8"	(315 mm)
13"	(331 mm)
14"	(356 mm)
15"	(381 mm)
16"	(406 mm)
17-1/2"	(445 mm)

**WEIGHT\***  
pounds (kilograms)

384 lbs.	(174 kg)
386 lbs.	(175 kg)
394 lbs.	(179 kg)
400 lbs.	(181 kg)
442 lbs.	(200 kg)
478 lbs.	(217 kg)
545 lbs.	(247 kg)
571 lbs.	(259 kg)

**FACES AVAILABLE**

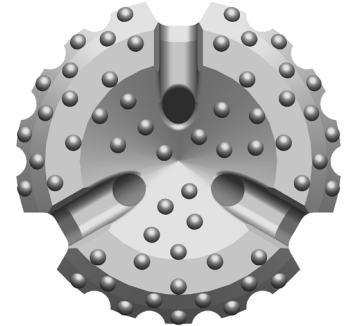

Concave

\* Bit weights are approximate

## FEATURES

- Concave face design for advanced hole cleaning capabilities
- 3/4" (19 mm) diameter carbide buttons throughout face
- Several grades and types of carbide are available
- Side wear buttons are available as an option
- Other bit sizes may be available upon request

**For More Information Contact:**

646 Thompson Road • Thompson, CT 06277 USA  
 Phone: (860) 923-9551 • Fax: (860) 923-2617  
[numa@numahammers.com](mailto:numa@numahammers.com) • [www.numahammers.com](http://www.numahammers.com)

