



**HAMMERS AND BITS**  
**Challenger® 6**  
**Down Hole**  
**Hammer**



**FEATURES**

- Valveless down hole hammer design
- Designed to operate at pressures up to 500 PSI (34.5 BAR)
- Hardened, reversible, non-ported case for extended life
- Delivers more energy per blow which results in higher penetration rates in hard rock
- For use in any hard rock application

**AIR CONSUMPTION**

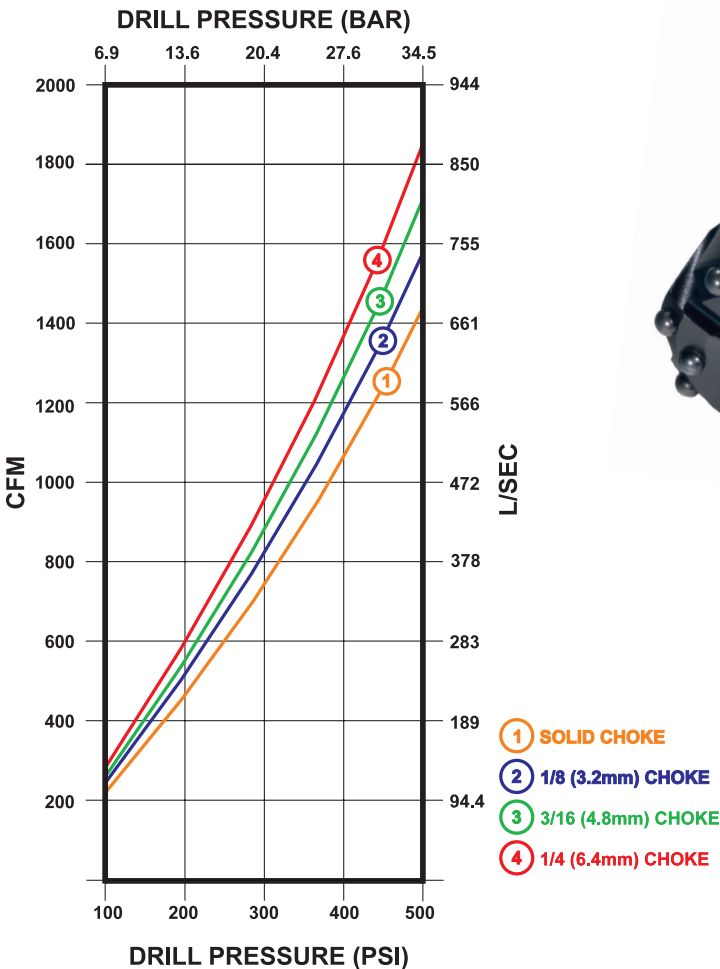

**SPECIFICATIONS**

Diameter	5-3/8"	137 mm
Bore	4-1/4"	108 mm
Stroke	4"	102 mm
Weight (Hammer only)	258 lbs.	117 kg
Length (Shoulder to Shoulder)	52"	132 cm
Length (Shoulder to Bit Face)	56"	142 cm
A.P.I. Reg. Threads	3-1/2	

- 1350 blows per minute at 350 PSI (23.8 BAR)
- Drills holes from 6" to 8-1/2" (152 mm - 216 mm) in diameter
- Accepts 360 bit shank

# Down Hole Button Bits

## Challenger® 6

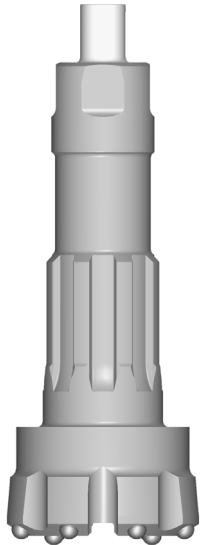

360 Bit Shank

**DIAMETER**  
inches (millimeters)

**WEIGHT\***  
pounds (kilograms)

**FACES AVAILABLE**

6"	(152 mm)	52 lbs.	(23.6 kg)
6-1/8"	(156 mm)	52 lbs.	(23.6 kg)
6-1/4"	(159 mm)	53 lbs.	(24.1 kg)
6-1/2"	(165 mm)	53 lbs.	(24.1 kg)
6-3/4"	(172 mm)	55 lbs.	(25.0 kg)
7"	(178 mm)	63 lbs.	(28.6 kg)
7-1/2"	(191 mm)	66 lbs.	(30.0 kg)
8"	(203 mm)	69 lbs.	(31.3 kg)
8-1/2"	(216 mm)	72 lbs.	(32.7 kg)

Concave

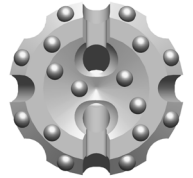

Convex



Flat

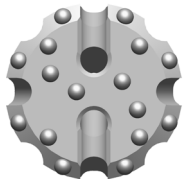

\* Bit weights are approximate

## FEATURES

- 5/8" (16 mm) diameter buttons throughout face
- Chipways designed for faster hole cleaning
- Carbide buttons positioned for better fracture of rock providing faster penetration rates
- Several grades and types of carbide are available
- Other bit sizes and carbide may be available upon request

### For More Information Contact:

646 Thompson Road • Thompson, CT 06277 USA  
Phone: (860) 923-9551 • Fax: (860) 923-2617  
numa@numahammers.com • www.numahammers.com

