



# Patriot® 35A

## Down Hole Hammer

### FEATURES

- Outdistances competitive hammers in both speed and longevity
- Simplified hammer design with less internal components
- Drills at high frequency to provide less vibration and smooth operation
- More efficient design requires less air which equals fuel savings
- Designed to operate at pressures up to 500 PSI (34.5 BAR)
- Ability to drill efficiently against high heads of water



### AIR CONSUMPTION

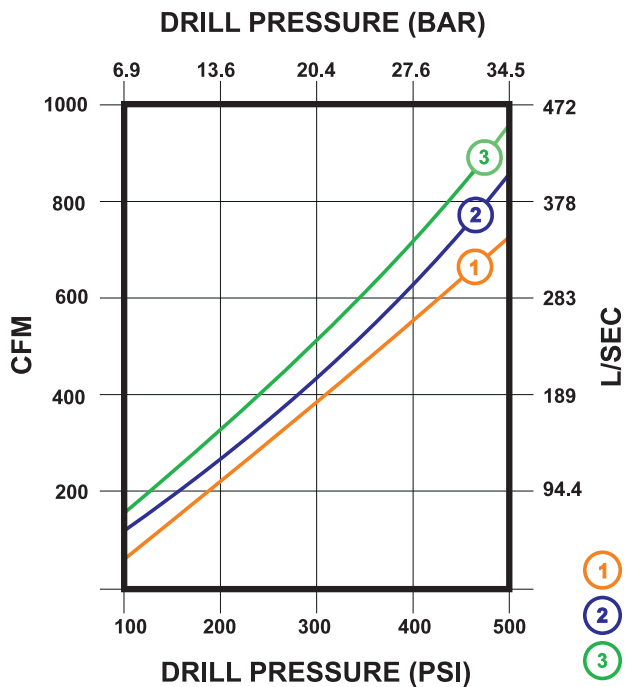

- ① SOLID CHOKE
- ② 1/8 (3.2mm) CHOKE
- ③ 3/16 (4.8mm) CHOKE

### SPECIFICATIONS

Diameter	3-1/8"	79 mm
Bore	2-1/2"	64 mm
Stroke	3-1/8"	89 mm
Weight (Hammer only)	46 lbs	21 kg
Length (Shoulder to Shoulder)	28-5/8"	728 mm
Length (Shoulder to Bit Face)	31-1/8"	791 mm
A.P.I. Reg. Threads	2-3/8	

- 1750 blows per minute at 350 PSI (23.8 BAR)
- Drills holes from 3-1/2" to 4-1/8" (89 mm - 105 mm) in diameter
- Accepts 3.5 bit shank



# Down Hole Button Bits

## Patriot® 35A

**DIAMETER**  
inches (millimeters)

**WEIGHT\***  
pounds (kilograms)

**FACES AVAILABLE**

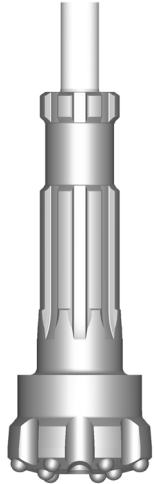

3.5 Bit Shank

3-1/2"	(89 mm)	14 lbs.	(6 kg)
3-5/8"	(92 mm)	14 lbs.	(6 kg)
3-3/4"	(95 mm)	14 lbs.	(6 kg)
4"	(102 mm)	15 lbs.	(7 kg)
4-1/8"	(105 mm)	15 lbs.	(7 kg)

\* Bit weights are approximate

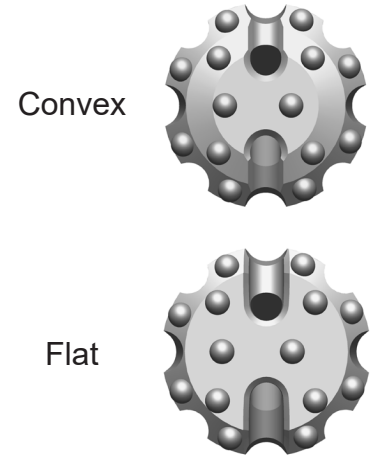

## FEATURES

- 7/16" (11 mm) diameter carbide buttons throughout face
- Carbide buttons positioned for better fracture of rock providing faster penetration rates
- Several grades and types of carbide are available
- Other bit sizes may be available upon request

### For More Information Contact:

646 Thompson Road • Thompson, CT 06277 USA  
 Phone: (860) 923-9551 • Fax: (860) 923-2617  
 numa@numahammers.com • www.numahammers.com

